

SEAL

TO THE BEST OF MY KNOWLEDGE, THE PLANS AND SPECIFICATIONS COMPLY WITH THE APPLICABLE MINIMUM BUILDING CODES AND THE APPLICABLE FIRE SAFETY STANDARDS AS DETERMINED BY THE LOCAL AUTHORITY IN ACCORDANCE WITH THIS SECTION AND ALL APPLICABLE STANDARDS.

KEN GARDNER
FL LA 1569

The logos for the participating firms are displayed in a grid. The top row features the 'idea Architect' logo, which consists of a light blue square containing the word 'idea' in a lowercase sans-serif font, with 'Architect' in a smaller font below it. The middle row features the '30th Anniversary FLYNN ENGINEERING' logo, which includes a circular emblem with '30th Anniversary' and '1984-2014' around a stylized '30', followed by the text 'FLYNN ENGINEERING' in a bold, blue, sans-serif font. The bottom row features the 'GS DESIGN' logo, which includes a stylized 'GS' in green and black, with 'DESIGN' in a blue box to the right.

[illegible]

ALL MEASUREMENTS MUST BE VERIFIED BEFORE
BEGINNING THE WORKS. NO MEASUREMENTS ARE TO
BE SCALED DIRECTLY FROM THIS DRAWING.

Key section

PROGRESS SET

Client

VERA FUND
NICK POLYUSHKIN
& YURI KHARITONENKOV
TEL: 305.833.3303

Project

**1600 S FEDERAL HIGHWAY
(MIXED-USE PROJECT)**

**1600 SOUTH FEDERAL HIGHWAY,
POMPANO BEACH, FL 33062**

Title

**SOIL VOLUME &
STRUCTURAL SOIL PLAN**

Drawn	Field
GSLA	LANDSCAPE ARCH
Verified	Scale
KG	as shown
Approved	Date
KG	10-09-2024

Project manager KG	Dwg. no. L-208
Project 01-208	

PZ24-1200027

03/05/2025

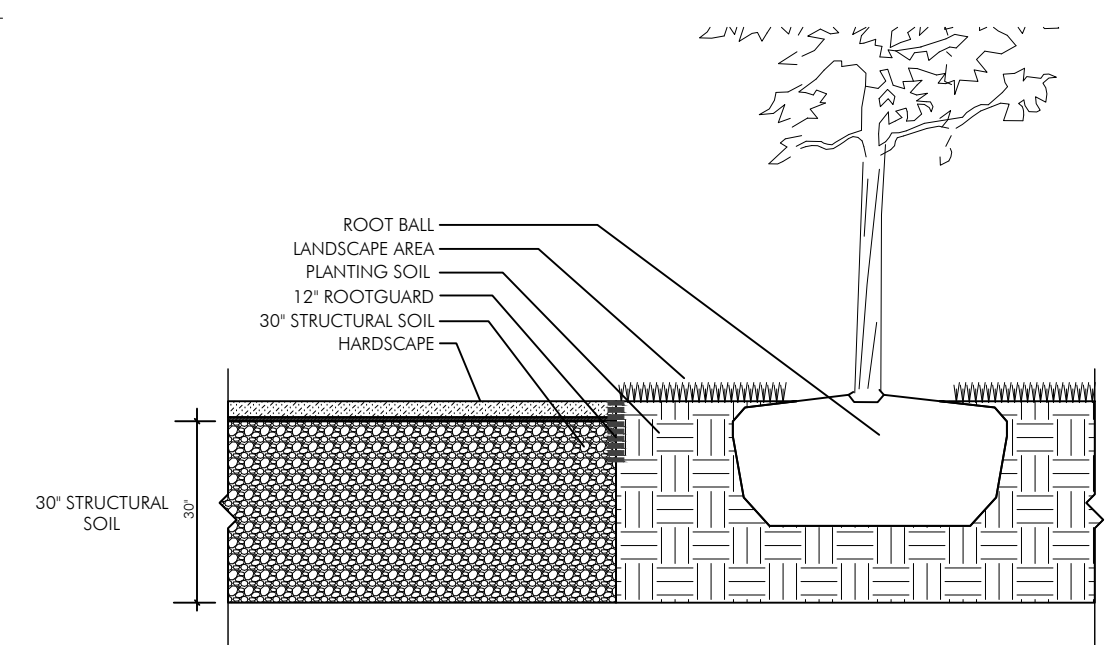
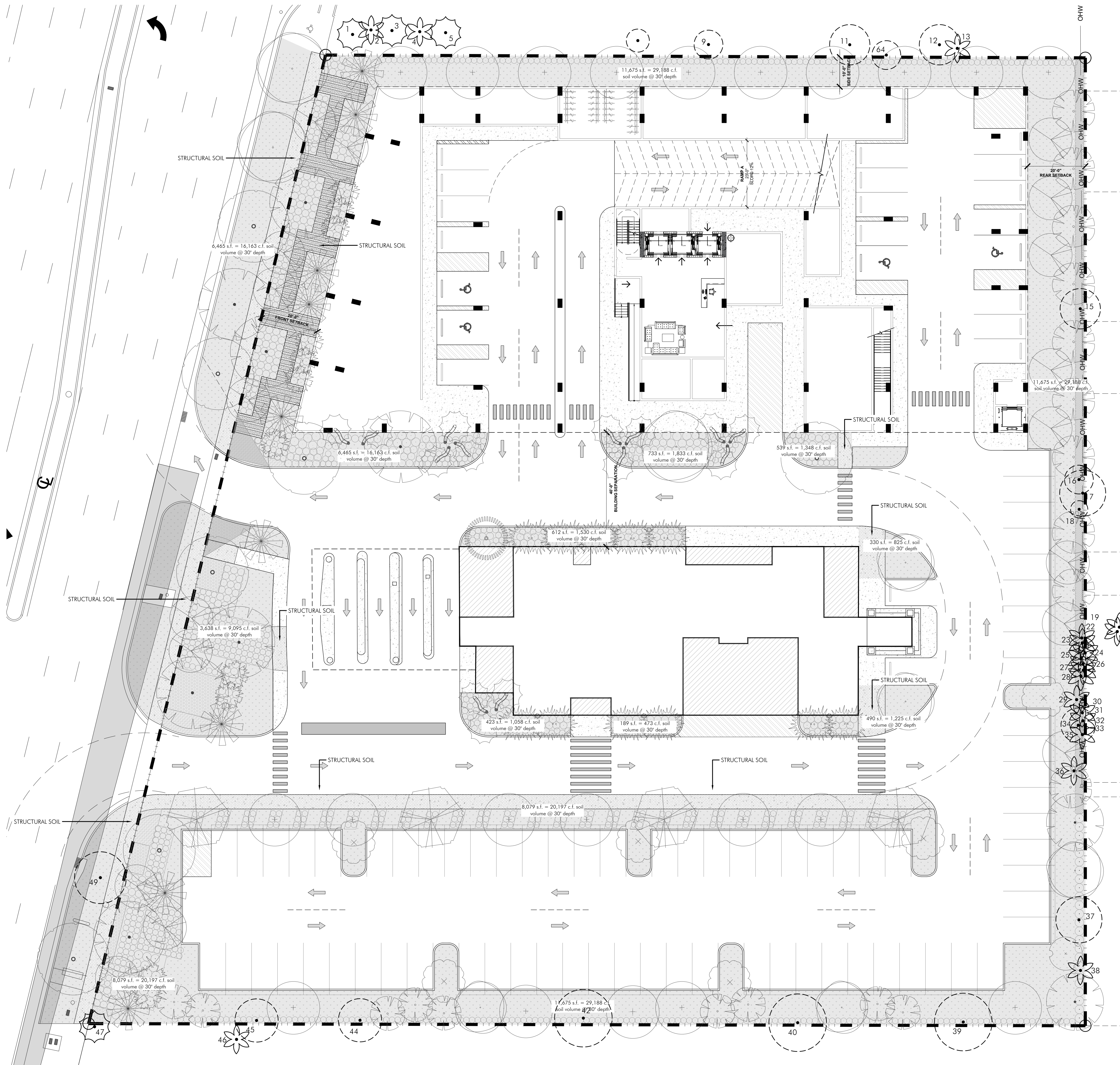

STRUCTURAL SOIL DETAIL (TYP.)

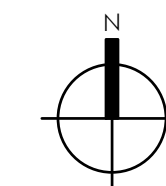

SOIL VOLUME PLAN

SCALE: 1/16" = 1'-0"